

REVISIONS				
REV	DESCRIPTION	REV BY	DATE	APPROVED
-	INITIAL RELEASE	N/A	04/22/2015	G. SAKONA

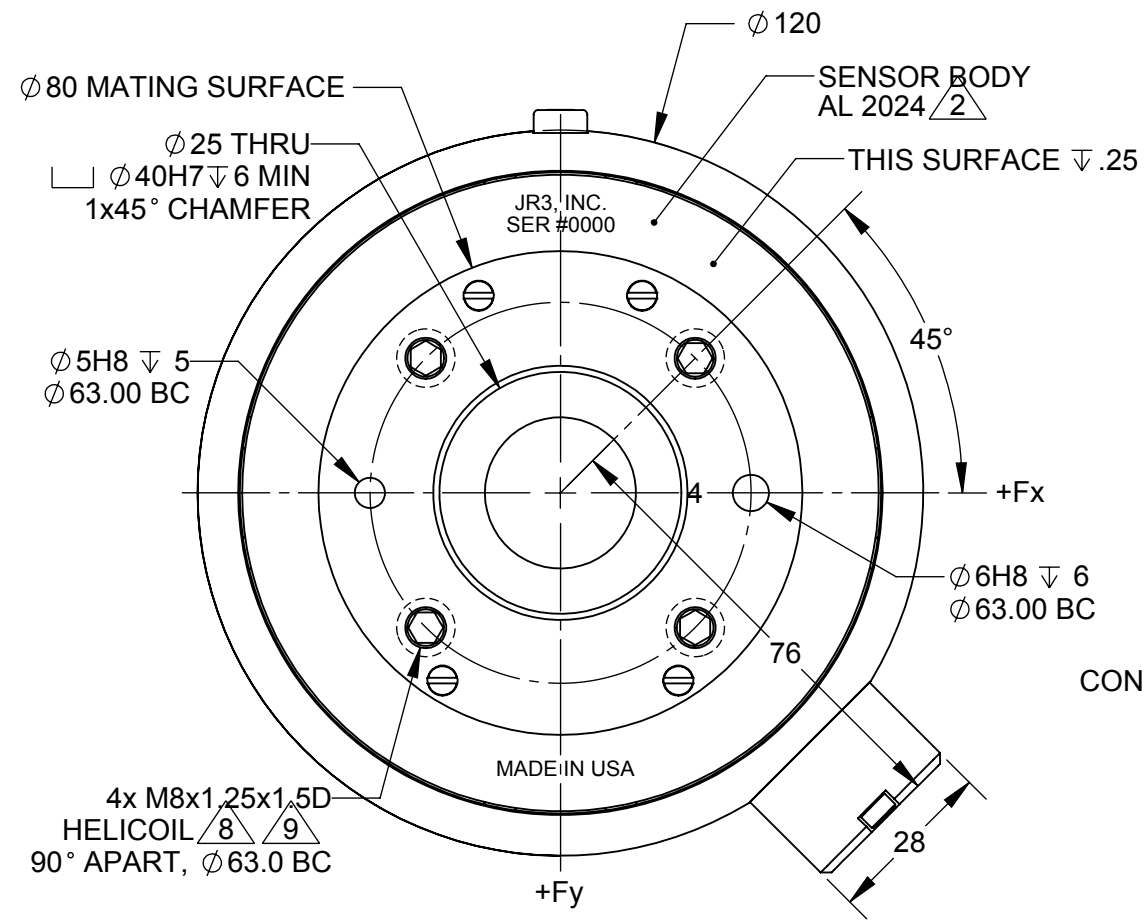

TOOL VIEW

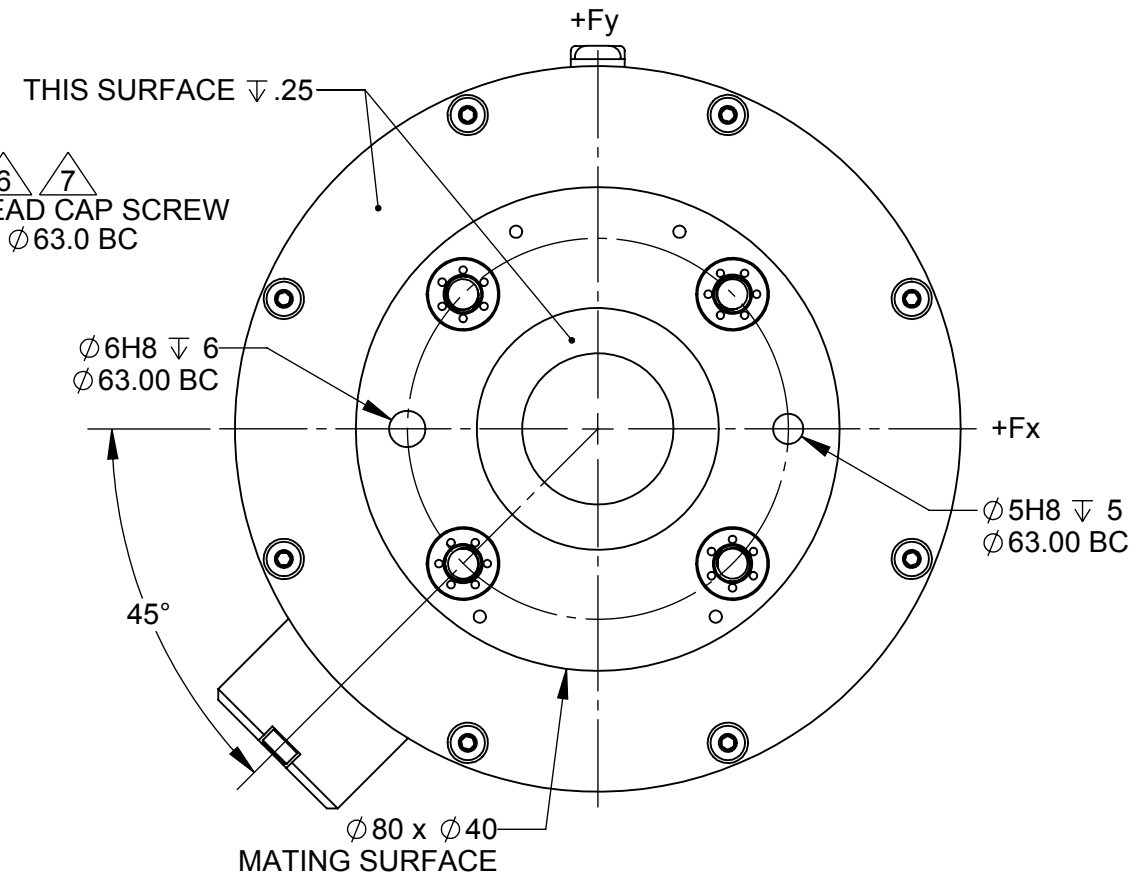
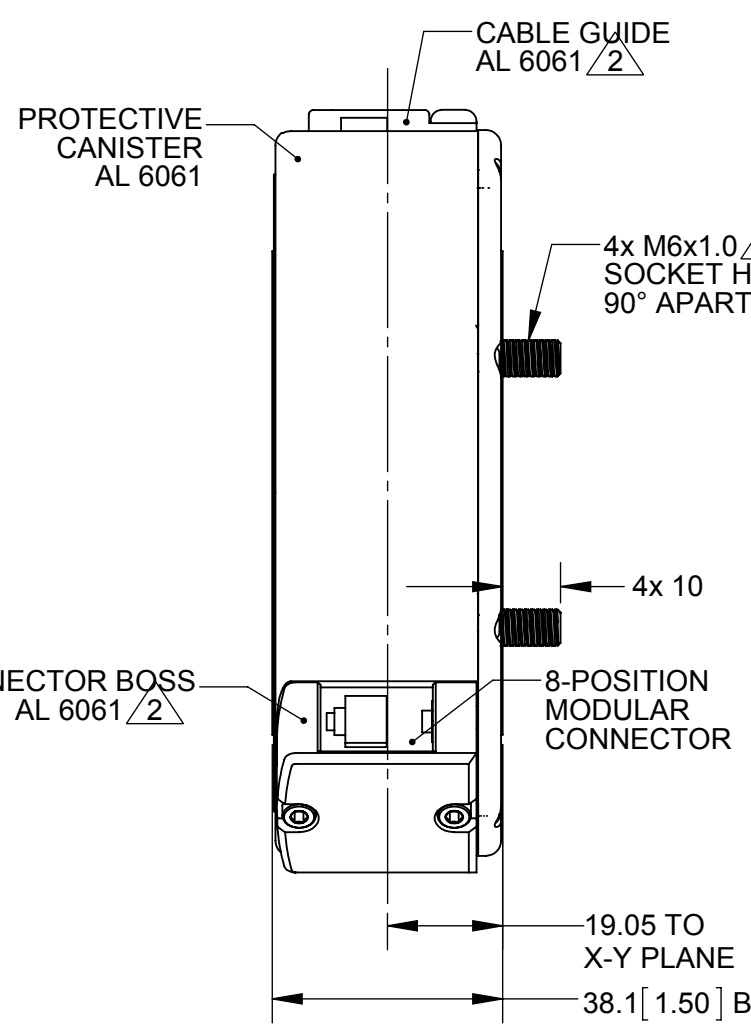

ROBOT VIEW

- NOTES:
- DIMENSIONS ARE IN MILLIMETERS [INCHES] UNLESS OTHERWISE NOTED.
 - ALUMINUM PARTS ARE ANODIZED. BLUE FOR CANISTER AND BOSS, BLACK FOR SENSOR BODY.
 - STANDARD LOAD RATINGS INCLUDE: 200N, 400N AND 1000N (50, 100 AND 250LB). WHERE MECHANICAL FULL SCALES (mFS) FOR EACH AXIS ARE AS FOLLOWS:
 Fx, Fy = LOAD RATING
 Fz = LOAD RATING * 2
 Mx, My, Mz = LOAD RATING * NOMINAL DIAMETER
 - ELECTRICAL FULL SCALES (eFS) CAN BE FACTORY-PRESET FROM 25% TO 100% OF mFS FOR EACH AXIS.
 - Fx AND Fy OUTPUTS SHOWN ASSUME OPPOSITE FACE IS HELD FIXED. Fz OUTPUT IS ALWAYS POSITIVE FOR TENSION. Mx, My, Mz OUTPUTS ALWAYS FOLLOW RIGHT HAND RULE.
 - BOLTS ARE CAPTIVE, RETRACTABLE, AND FREE TO ROTATE. TIGHTEN WITH HEX KEY THRU TOOLSIDE HOLES. TORQUE M6 CAPTIVE BOLTS TO 13 Nm (120inlb) IN 3 STEPS: SNUG, HALF, FULL. FOLLOWING AN ACBD SEQUENCE.
 - MAXIMUM ALLOWED PENETRATION OF M8 MOUNTING BOLTS INTO SENSOR TOOLSIDE IS 12mm (.50in).
 - TORQUE M8 MOUNTING BOLTS TO 32 Nm (280 in-lb) IN 3 STEPS: SNUG, HALF, FULL. FOLLOWING AN ACBD SEQUENCE.

TITLE: INTERFACE, 45E15 SENSOR, M63J BOLT PATTERN, DIGITAL

TOLERANCES: (UNLESS OTHERWISE NOTED)	X = ±.25mm .X = ±.10mm .XX = ±.025mm ANGLES = ±0.1°	DWG SIZE: B	DRAWN BY: K. NIELSEN
		SCALE: 4:5 AND NOTED	DWG NO: 48002
			REV: -

JR3, INC. WOODLAND, CA 95776

SHEET 1 OF 1